

RED HEART CUDDLE UP CROCHET BLANKET



BULKY
  CROCHET | SKILL LEVEL: **EASY**

ABBREVIATIONS

- Approx** = Approximately
- Beg** = Beginning
- Ch** = Chain(s)
- Lp st** = Loop stitch (worked on WS) = Insert hook in next stitch. Wrap working yarn over top of index finger, from front to back, to form 2" [5 cm] loop. Placing tip of hook behind yarn at front of index finger, Yoh and draw up a loop onto hook. Yoh and draw through 2 loops on hook, dropping loop off index finger to back of work (see diagram). Loop will be formed on RS of work.
- Pat** = Pattern
- Rem** = Remain(ing)
- Rep** = Repeat
- RS** = Right side
- Sc** = Single crochet
- Scbl** = Single crochet in back loop only of next stitch
- St(s)** = Stitch(es)
- Tog** = Together
- Tr** = Treble crochet
- WS** = Wrong side
- Yoh** = Yarn over hook

MATERIALS

Red Heart® Hygge™ (5 oz/141 g; 132 yds/121 m)	
Contrast A Forest (8633)	2 balls or 191 yds/175 m
Contrast B Aloe (8631)	2 balls or 250 yds/229 m
Contrast C Sterling (8340)	2 balls or 230 yds/211 m
Red Heart® Hygge™ (8 oz/227 g; 212 yds/194 m)	
Contrast D Indigo (8381)	2 balls or 250 yds/229 m
Contrast E Pearl (8406)	4 balls or 848 yds/776 m
Contrast F Cloud (8339)	4 balls or 658 yds/602 m
Size U.S. L/11 (8 mm) crochet hook or size needed to obtain gauge. Stitch marker.	

Lp st

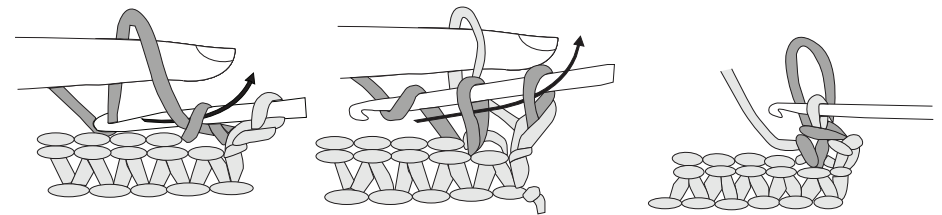

MEASUREMENTS

Approx 49" x 59" [124.5 x 150 cm], excluding fringe.

GAUGE

10 sc and 12 rows = 4" [10 cm].

Notes:

- Worked over foundation chain multiple of 4 ch.
- To change color, work to last loops on hook of previous color. Yoh with new color, draw through rem loops and proceed with new color.

With A, ch 124.

1st row: (RS). 1 sc in 2nd ch from hook. 1 sc in each ch to end of chain. Turn. 123 sts.

2nd row: Ch 1. 1 sc in each sc across. Turn.
Rep last row until work from beg measures 6" [15 cm], ending on a WS row. Join B. Break A. Turn.

With B, proceed as follows:

****1st row:** (RS). Ch 1. 1 sc in each sc across. Turn.

2nd row: Ch 1. 1 Lp st in each sc across. Turn.
Rep last 2 rows for Lp St Pat until work from last color change measures 4½" [11.5 cm], ending on a WS row. ** Join A. Break B.

Next row: (RS). With A, ch 1. 1 sc in each st across. Turn.
Rep last row until work from last color change measures 2" [5 cm], ending on a WS row. Join C. Break A.

Next row: (RS). With C, ch 1. 1 sc in each sc across. Turn.
Rep last row until work from last color change measures 2" [5 cm], ending on a WS row. Join D. Break C.

With D, rep from ** to **. Join E. Break D. Turn.

With E, proceed as follows:

Note: On WS rows, push tr sts to RS of work to form Bobbles.

*****1st row:** (RS). Ch 1. 1 sc in each st across. Turn.

2nd row: Ch 1. 1 sc in each of first 3 sc. *1 tr in next sc. 1 sc in each of next 3 sc. Rep from * to end of row. Turn.

3rd row: Ch 1. 1 sc in each st across. Turn.

4th row: Ch 1. 1 sc in first sc. 1 tr in next sc. 1 sc in next sc. *1 sc in each of next 2 sc. 1 tr in next sc. 1 sc in next sc. Rep from * to end of row. Turn.***
Rep last 4 rows for Bobble St Pat until work from last color change measures 18" [45.5 cm], ending on a RS row. Join C. Break E.

Next row: (WS). With C, ch 1. 1 sc in each sc across. Turn.
Rep last row until work from last color change measures 4" [10 cm], ending on a WS row. Join F. Break C. Turn.

Next row: (RS). With F, ch 1. 1 scbl in each sc across. Turn. PM at end of row.

Next 3 rows: Rep 2nd to 4th rows as given for Bobble St Pat once.
Rep from *** to *** as given for Bobble St Pat until work from beg measures 59" [150 cm] ending on a RS row
Fasten off.

FINISHING

Body Fringe: Cut strands of C 8" [20.5 cm] long. Taking 3 strands tog, fold in half and knot into fringe in every other rem loop across last marked row of Blanket at RS of work. Trim fringe evenly.

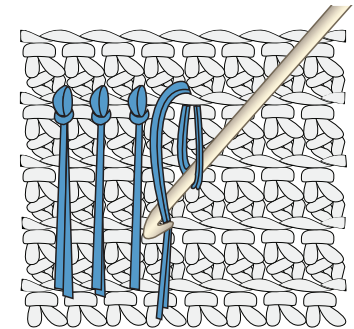

Edge Fringe: Cut strands of E 12" [30.5 cm] long. Taking 3 strands tog, fold in half and knot into fringe in every other st across top and bottom edges of Blanket. Trim fringe evenly.

