



**Version 1**

**Version 2**

## MATERIALS

**Caron® x Pantone™** (3.5 oz/100 g; 127 yds/116 m)

### Version 1 or Version 2

**Main Color (MC)** Dane Gray (01003)      **1 braid**

**Contrast** Provincial Lilac (01013)      **1 braid**

Size U.S. 10 (6 mm) knitting needles **or size needed to obtain gauge.**

**MC - 18-0000**

### Version 1

**A - 11-4302**   **B - 14-4203**   **C - 15-3912**   **D - 16-1412**   **E - 18-1404**

### Version 2

**A - 14-4203**   **B - 18-1404**   **C - 11-4302**   **D - 15-3912**   **E - 16-1412**

 **KNIT | SKILL LEVEL: EASY**

## ABBREVIATIONS

**Alt** = Alternat(e)(ing)

**Approx** = Approximate(ly)

**Beg** = Begin(ning)

**Cont** = Continue(ity)

**K** = Knit

**K2tog** = Knit next 2 stitches together

**Kfb** = Increase 1 stitch by knitting into front and back of next stitch

**P** = Purl

**Pat** = Pattern

**Rem** = Remaining

**Rep** = Repeat

**RS** = Right side

**St(s)** = Stitch(es)

**WS** = Wrong side

## SIZE

One size to fit Adult.

## GAUGE

14 sts and 26 rows = 4" [10 cm] in garter st.

## INSTRUCTIONS

### Notes:

- Before working with Caron® x Pantone™ multi-shade yarn braid, separate each color link and wind into 5 separate balls for each braid.

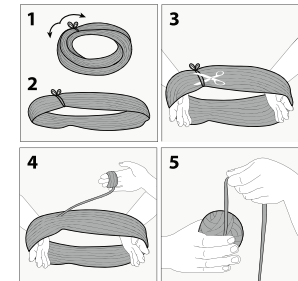

- Each color link will be referenced by its Pantone™ color # (see label).

- Designate each different shade of 5 separate colors as Contrast A, B, C, D and E as noted in Materials section (or as desired).
- Due to finite amount of yarn in each shade, pattern gauge must be matched to ensure successful results

## Stripe Pat

### Version One

With A, knit 4 rows.  
 With B, knit 2 rows.  
 With A, knit 2 rows.  
 With B, knit 4 rows.  
 With C, knit 2 rows.  
 With B, knit 2 rows.  
 With C, knit 4 rows.  
 With D, knit 2 rows.  
 With C, knit 2 rows.  
 With D, knit 4 rows.  
 With E, knit 2 rows.  
 With D, knit 2 rows.  
 With E, knit 4 rows.  
 With A, knit 2 rows.  
 With E, knit 2 rows.  
 These 40 rows form Stripe Pat.

### Version Two

With B, knit 4 rows.  
 With E, knit 2 rows.  
 With B, knit 2 rows.  
 With E, knit 4 rows.

With A, knit 2 rows.  
 With E, knit 2 rows.  
 With A, knit 4 rows.  
 With C, knit 2 rows.  
 With A, knit 2 rows.  
 With C, knit 4 rows.  
 With D, knit 2 rows.  
 With C, knit 2 rows.  
 With D, knit 4 rows.  
 With B, knit 2 rows.  
 With D, knit 2 rows.  
 These 40 rows form Stripe Pat.

With MC, cast on 70 sts.

**1st row:** (RS). \*K2. P2. Rep from \* to last 2 sts. K2.

**2nd row:** \*P2. K2. Rep from \* to last 2 sts. P2.

Rep last 2 rows until work from beg measures 2½" [6 cm], ending on a RS row.

**Next row:** (WS). \*Rib across 13 sts. Kfb. Rep from \* to last 14 sts. Rib to end of row. 74 sts.  
 Break MC.

### Beg Stripe Pat

Proceed in Stripe Pat, knit every row (garter st), until work from beg measures 7" [18 cm], ending on a WS row.

## Shape top

Keeping cont of Stripe Pat, proceed as follows:

**1st row:** (RS). (K23. K2tog) twice. Knit to end of row. 72 sts

**2nd and alt rows:** Knit.

**3rd row:** \*K7. K2tog. Rep from \* to end of row. 64 sts.

**5th row:** \*K6. K2tog. Rep from \* to end of row. 56 sts.

**7th row:** \*K5. K2tog. Rep from \* to end of row. 48 sts.

**9th row:** \*K4. K2tog. Rep from \* to end of row. 40 sts.

**11th row:** \*K3. K2tog. Rep from \* to end of row. 32 sts.

**13th row:** \*K2. K2tog. Rep from \* to end of row. 24 sts.

**15th row:** \*K1. K2tog. Rep from \* to end of row. 16 sts.

Break yarn, leaving a long end. Thread end through rem sts and fasten securely. Sew back seam.

**Pom-pom:** Wind MC around 4 fingers approx 90 times. Remove from fingers and tie tightly in center. Cut through each side of loops. Trim to smooth round shape. Attach pom-pom to top of Hat as shown in photo.

VERSION 1



VERSION 2

